





TYPE - A



TYPE - B

FEATURES



Vitrify Flooring
2 X 2



Birla Putty In Side
All Rooms & Outside
Good Quality Color



Aluminum
Sliding Window
(Color Anodize)



Aluminum Section
Doors in all Bathrooms
(Color Anodize)



Full Tiles In All
Bathrooms



Parking Tiles In
Parking Area



Iron Main Gate
& Railing



Registered Branded
Cement (Sanghi -
Ultratech)



“ Building Your Dreams
With Perfection ”

Plot Area **78.46 Sq.Yd**

S. Builtup Area **550.00 Sq.Ft.**

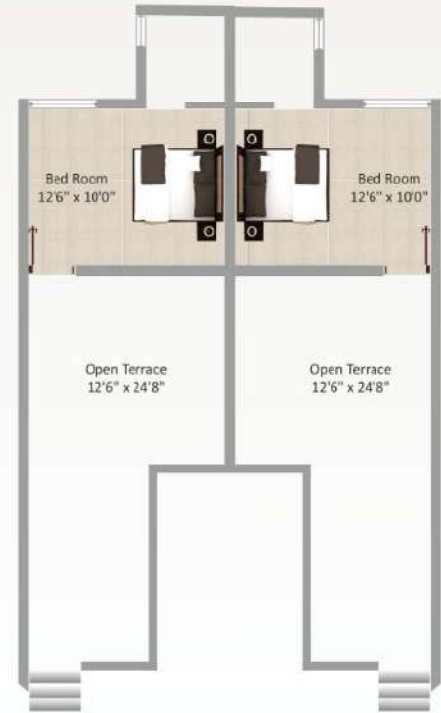

Optional



Conceal Wiring & Modular Switches



Inverter In Each Block



Tiles In Kitchen Up To Lintel Level In All Wall



Kitchen Platform Black Granite



Tube Lights & Fan In All Rooms



Water Filter In Each Block



500 Ltr Water Tank on Terrace



All Doors Flush Doors



Construction With Cement Blocks



Tiles On Terrace



SILVER SAND RESIDENCY



: BOOKING DETAILS :
98791 34525, 99749 21414

: PROJECT BY :



: PROJECT CONSULTANT :

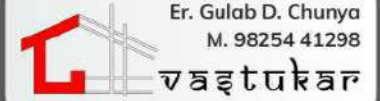

: HEAD OFFICE :

Gayatri Complex, In Front Of Hotel For Way,
Shakti Nager, Mundra – 370421

: LEGAL ADVISOR :

Bharat M. Thakker (M.A., L.L.B (Spe.)
M : 97251 81800

